



ALL DIRECTIONS ARE GIVEN RELATIVE TO THE RUNNING DIRECTION.

Start: On Fanok at Utility Pole JC97__25K on the left.

Mile 1: On Woodland at trailing edge of front door to #165 on the right and 57 feet before unmarked utility pole on the left between #164 and #170.

Mile 2: On Spring Valley after Quarter Ridge and just after the driveway to #49 on the right, 36 feet 2 inches after utility pole 1599MT on the right.

Mile 3: On South St., 2 feet before utility pole C1521MT on the right.

Finish: On Dwyer, 2 feet after the gas valve cap on left in the grass and east of the Fire Station driveway.

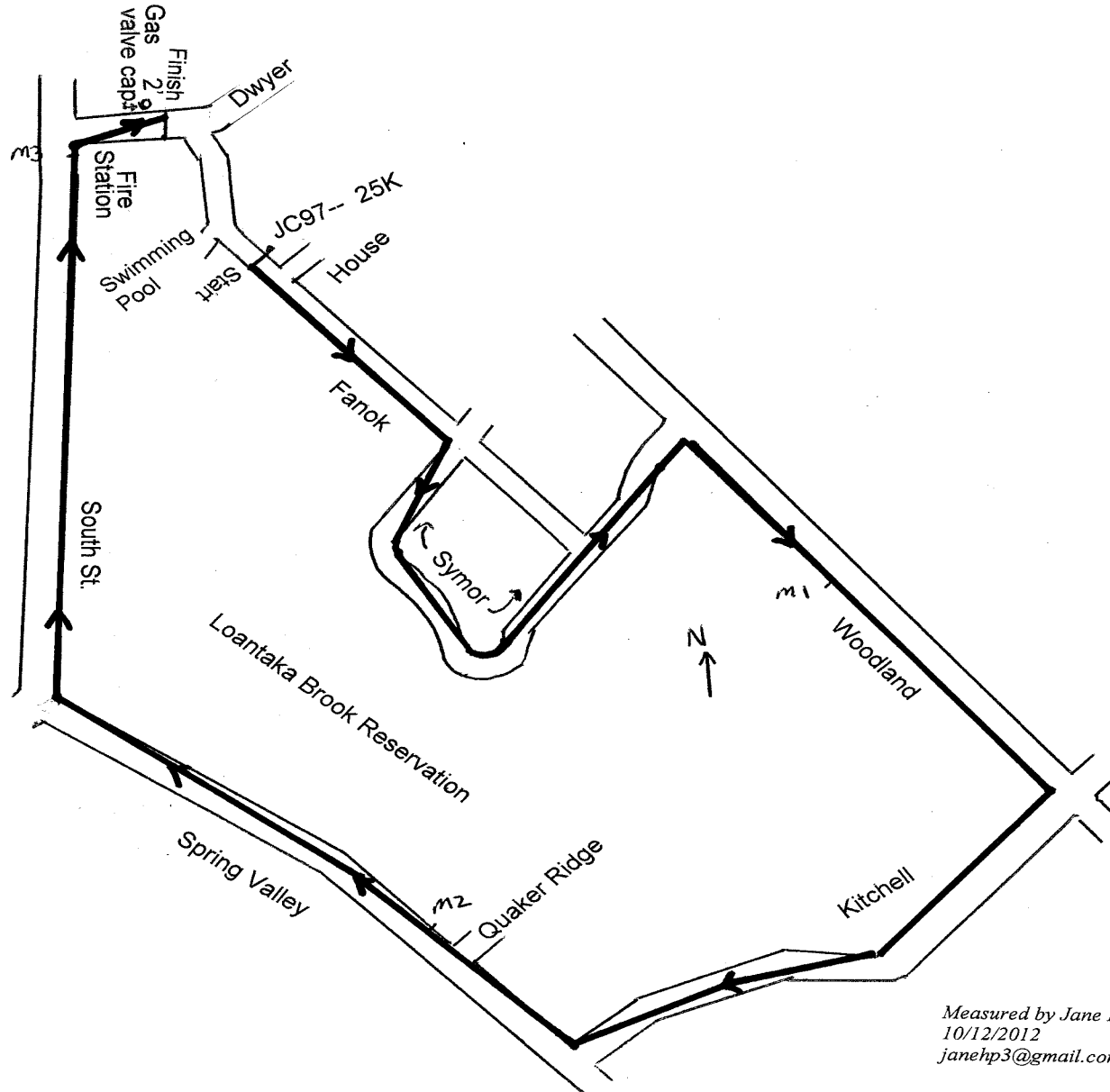

Measured by Jane H. Parks
10/12/2012
janehp3@gmail.com